

# UCONNECT 2015 Student Conference *at* UCSB

Sponsored by UCONNECT Transportation Center,  
UCSB College of Letters and Science, and UC ITS MRPI in Sustainable Transport



## Conference Program

Friday, February 27

Time	Workshop		Location
<b>08:30</b>	Breakfast		Lagoon Lawn
<b>09:00</b>	Workshop 1	Presentations	SB Harbor
<b>10:30</b>	Workshop 2	Presentations	SB Harbor
<b>12:00</b>	Workshop Lunch		Lagoon Lawn
<b>13:00</b>	Workshop 3	Discussion	SB Harbor
	Conference		
<b>15:00</b>	Registration Start		UCen Front
<b>16:00</b>	<i>Student of the Year Talk</i>	Jack Reilly	SB Harbor
<b>16:30</b>	<i>Welcome Talk</i>	Prof. Keith Clarke, UCSB	SB Harbor
<b>17:00</b>	Reception	Appetizers + Drinks	State Street + Lawn
<b>18:00</b>	“Pass the Mic” Posters	Posters/Lightning Talks	SB Harbor
<b>19:30</b>	Executive Committee Meeting		Lobero

## Saturday, February 28

Time	Conference	Location	
<b>08:00</b>	Expanded Advisory Committee Meeting	Flying A Studio	
<b>08:30</b>	Registration, Poster setup, and Breakfast	Corwin Pavilion	
<b>09:20-10:10</b>	<i>Opening Remark</i>	Kostas Goulias	
		Michael Cassidy	
	<i>Keynote</i>	Katie Benouar	
		Coco Briseno	
<b>10:20-12:00</b>	Morning Podium Sessions	-----	
	Morning A	Transit	SB Harbor
	Morning B	Systems Modeling and Simulation	Lobero
	Morning C	Urban Environments 1: Travel Behavior	State Street
<b>12:00</b>	Lunch	Corwin + Plaza	
<b>13:00-14:40</b>	Afternoon Podium Sessions 1	-----	
	Afternoon 1A	#Trending	SB Harbor
	Afternoon 1B	Systems Optimization and Operations	Lobero
	Afternoon 1C	Urban Environments 2: Multimodal	State Street
<b>14:40</b>	Saturday Posters	Coffee and Snacks	Corwin Pavilion
<b>16:00-17:00</b>	Afternoon Podium Sessions 2	-----	
	Afternoon 2A	Time and Money	SB Harbor
	Afternoon 2B	Transportation and the Environment	Lobero
	Afternoon 2C	Urban Environments 2: Urban Change	State Street
<b>17:30</b>	Advisory Panel – Questions from Students	Corwin Pavilion	
<b>18:30</b>	Dinner	Corwin Pavilion	
	Mel Webber Lecture	Prof. Hani Mahmassani, Northwestern	
	Awards and Thank-Yous		

## Morning Podium Sessions

10:20 – 12:00

Morning A – Transit – SB Harbor

Slot	Author	Institution	Title
1	Eleanor Leshner and Sara Barz	UC Berkeley	Trouble at the Fare Gates: Understanding barriers to providing seamless regional fare payment in the San Francisco Bay Area
2	Christina Blackston and Janice Park	UC Berkeley	A Streetcar Named Desire
3	Drew Levitt	UC Berkeley	Efficiency and Equity in Public Transit: Informing Subjective Choices with Objective Measures
4	Lee Reis	UC Berkeley	BRT in CLE: A Model for American Transit Development?
5	Jeremiah LaRose	UC Los Angeles	Improving Local Bus Networks In Context With Lessons from BRT

Morning B – Systems Modeling and Simulation – Lobero

Slot	Author	Institution	Title
1	Jiangbo Yu	UC Irvine	An Information-based Framework for Modeling Perceived Travel Time Uncertainty
2	Xuewei Qi	UC Riverside	An on-line energy management strategy for plug-in hybrid electric vehicles using an Estimation Distribution Algorithm
3	Paul Anderson	UC Berkeley	Associations Generation in Synthetic Population for Transportation Applications: A Graph-Theoretic Solution
4	Song Gao	UC Santa Barbara	Detecting Origin-Destination Mobility Flows From Geotagged Tweets in Greater Los Angeles Area
5	Nate Isbell	UC Santa Barbara	Modeling second-by-second emissions in a mega-region

Morning C – Urban Environments 1: Travel Behavior – State Street

Slot	Author	Institution	Title
1	Monica Villalobos	UC Berkeley	Mobility Networks: Challenging Transportation Planning and Technocratic Decision-Making in U.S. Minority Communities
2	Kelcie Ralph	UC Los Angeles	Stalled on the road to adulthood
3	Evan Moorman	UC Los Angeles	Combating Residential Segregation in Swedish Municipal Housing
4	Ashley Lo	UC Irvine	Does Compact Development Provide an Equal Travel Environment for Men and Women? A Case Study of Los Angeles County
5	Derek Cheah	UC Berkeley	Where's the D? Missing Development around Transit-Oriented Development

## Afternoon Podium Sessions 1

13:00 – 14:40

Afternoon 1A – #Trending – SB Harbor

Slot	Author	Institution	Title
1	Maitagorri Schade	UC Berkeley	The impact of 21st century transportation modes on travel behavior
2	Feras El Zarwi	UC Berkeley	From Trend Spotting to Trend Setting: Modeling the Impact of Major Technological and Infrastructural Changes on Travel Demand
3	Neda Masoud	UC Irvine	Ride-Matching Problem in Peer-to-Peer Multi-Hop Ridesharing Systems with Stochastic Demand
4	Ryan Sclar	UC Los Angeles	Stop Signs and Bicycle Accessibility
5	Jana Schwartz	Cal Poly SLO	Cargo Bike Ownership: Does it increase active transportation?

Afternoon 1B – Systems Optimization and Operations – Lobero

Slot	Author	Institution	Title
1	Roger Lloret-Batlle	UC Irvine	Online Auction Designs for Traffic Intersection Operations
2	Xiyang Wang	UC Irvine	1-Hub or 2-Hub networks? A Theoretical Analysis of the Optimality of Airline Network Structure
3	Xingyan (David) Kan	UC Berkeley	Coordination of Freeway Ramp Metering and Arterial Traffic Signal
4	Peter Kozey	UC Berkeley	Simultaneous Left-Turn Intersection
5	Zahra Amini	UC Berkeley	Exploring alternative schemes to serve transit corridors

Afternoon 1C – Urban Environments 2: Multimodal – State Street

Slot	Author	Institution	Title
1	Brianne Masukawa	UC Los Angeles	Westwood Goes Multimodal!
2	Anne Brown	UC Los Angeles	Does Bus Rapid Transit Gentrify Neighborhoods? Evidence from Los Angeles
3	Ben Kaufman	UC Los Angeles	Re-Inventing the Bus Stop: Guidelines and Analysis for Transit-Friendly Parklets in California's East Bay
4	Lewis Lehe	UC Berkeley	The Walkable Neighborhood and Parking in Equilibrium
5	Germano Johansson	U of Southern California	Water buses feasibility in Ilheus, Brazil

## Afternoon Podium Sessions 2

16:00 – 17:00

### Afternoon 2A – Time and Money – SB Harbor

Slot	Author	Institution	Title
1	Carole Voulgaris	UC Los Angeles	A TUF Sell: Transportation Utility Fees as User Fees
2	Ke Wang	UC Irvine	Financing, Timing, and Capacity of a New Intercity Highway when Traffic Demand is Uncertainty: The BOT Case
3	Harya Dillon	UC Irvine	The Impact of Urban Form and Gasoline Prices on Vehicle Usage: Evidence from the 2009 National Household Travel Survey

### Afternoon 2B – Transportation and the Environment – Lobero

Slot	Author	Institution	Title
1	Tammie Kuo	UC Irvine	San Pedro Bay Ports Clean Air Analysis
2	Jaimee Lederman	UC Los Angeles	Transportation and Habitat Conservation Plans: Improving Planning and Project Delivery While Preserving Endangered Species
3	Liem Pham	UC Riverside	Monitoring nanoparticles on major highways in Southern California: A Lagrangian approach using a mobile monitoring system

### Afternoon 2C – Urban Environments 3: Urban Change – State Street

Slot	Author	Institution	Title
1	Adam Koling	UC Berkeley	Driven Underground: The Street, the Car, the Streetcar, and San Francisco's Market Street Corridor
2	Andrea Broaddus	UC Berkeley	Longer-term impacts of the London congestion charge
3	Dana Rubin	UC Berkeley	Persisting social and economic inequities along the Century Freeway corridor In Los Angeles, CA.

Friday “Pass the Mic” Poster Session 18:00-19:30

SB Harbor

All Friday poster presenters are invited to prepare a brief (2-4 minute) lightning talk discussing the highlights of their work, to be given in front of their poster at the start of the session. After all participants have spoken, the remainder of the time will provide a chance for informal discussion between presenters and attendees.

Author	Institution	Title
Pierre Auza	UC Irvine	Using Stakeholder Interviews to Identify System Functionality Metrics for Use in Resilience Measurement
Huajun Chai	UC Davis	Dynamic traffic routing in a network with adaptive signal control
David Leipziger	UC Los Angeles	Mutiny on the County? How Hollywood, Inglewood, and Baldwin Hills Explain the Political Geography of Los Angeles County
Rachel Lindt	UC Los Angeles	The Avalon Green Alley Network Demonstration Project: Lessons Learned from Previous Projects and Programs to Aid in Green Alley Development in LA and Beyond
Jill Luo	UC Riverside	Incorporating Exposure to Traffic-related Air Pollution in Walkability Evaluation
Rui Ma	UC Davis	Optimization of Traffic Signal Control with User Equilibrium and Queue Spillbacks
Jimmy Nguyen	Cal Poly Pomona	Exploration of a Suitable Time Period for a Macrolevel Safety Analysis in California
Thinh Nguyen	Cal Poly Pomona	Spillover Assessment of System-Wide Adaptive Ramp Metering (SWARM) Control on I-210
Casey Osborn	UC Los Angeles	Between a RUC and a Hard Place: Road User Charges in California and the Implications for California Counties
Daniel Rodriguez Roman	UC Irvine	Accounting for population exposure to air pollutants in the toll design problem
Nathalie Saade	UC Berkeley	Effects of Segregating Buses and Cars in a Congested, Non-Steady State Network
Michael Samuelson	UC Los Angeles	Identifying Problem Points on Los Angeles Metro Rapid
Daniel Shockley and Manuel Santana	UC Los Angeles	The Transportation and Land Use Correlation: An Analysis from the Millennium Cities Database
Leslie Situ and Cameron Weiss	Cal Poly Pomona	Weighted Decision Matrix to Select Preferred Alternative
Jenny Yu	UC Los Angeles	Decision-Making in the Planning of Public Transit and Its Effect on Rail Stations in in Los Angeles

## Saturday Poster Session

14:40 –16:00

Corwin Pavilion

Up to 10 presenters in this session may present a brief (2-4 minute) lightning talk discussing the highlights of their work, to be given in front of their poster at the start of the session. The remainder of the time will provide a chance for informal discussion between presenters and attendees.

Presenters as of now († = Confirmed Lightning talk):

Author	Institution	Title
Abhinav Bhattacharyya	UC Berkeley	Nudging People Towards more Sustainable Residential Choice Decisions: An Intervention Based on Focalism and Visualization
Samuel Blanchard	UC Berkeley	AC Transit Service and Transit Dependent Neighborhoods in Oakland, CA
Cedric Bourdais	UC Berkeley	Automated Assessment of Safety-Critical Dynamics in Multi-modal Transportation Systems
Marc Caswell†	UC Los Angeles	Re-Cycling Ideas: California's Earliest Bikeway Planning Rediscovered 50 Years Later
Wen Cheng	Cal Poly Pomona	Ranking Cities for Safety Investigation by Potential for Safety Improvement
Abigail Cochran	UC Berkeley	On Proximity to Transit-Oriented Development and Automobile Use: A Case Study of the Fruitvale Neighborhood in Oakland, CA
Kevin Fang†	UC Davis	Safety indicators for skateboarding as a mode of active transportation: Injury, fatality, and incident data
Duaa Gettani	UC Davis	Achieving low-carbon transport in the Middle East/North Africa
Brianna Goodman	UC Davis	Providing Equitable Access to Sacramento's Bike Share System
Nicholas Gysel	UC Riverside	Effect of Biodiesel Feedstock on Regulated Emissions, Gaseous Toxics, and Ultrafine Particles From Two Trucks Fitted With and Without Aftertreatment Controls
May-Ling Lu	UC Riverside	Theoretical Ethanol Yield of California Agave
Suman Mitra	UC Irvine	Value of Transportation Accessibility in a Least Developed Country. The Case Rajshahi City, Bangladesh.
Janice Park†	UC Berkeley	Information Display for Transportation Mobile Apps: Data, Game, or Some of Each?
Rosalie Ray	UC Los Angeles	Open for business: Impacts to businesses during Metrorail construction
Robert Regue	UC Irvine	Car2Work: A new mobility concept to connect Commuters to Workplaces
Allan Rimbant†	San Jose State University	How Do US Transit Officials Approach Fare Policy?
Paul Sohn	UC Berkeley	Bikeway Coverage and Equity in Oakland, CA
Anne Spevack	UC Berkeley	The smart growth balance sheet: Investigating the economic costs and benefits of the San Jose Midtown Specific Plan



Kelan Stoy	UC Berkeley	The Rent is Too Damn High: Parking and Affordability in Portland, OR
Ashley Vizenor	UC Riverside	Cloud condensation nuclei activity of secondary organic aerosol from the photooxidation of uncombusted gasoline
Zackary Wallace	UC Los Angeles	Addressing Denver's commuter rail park-and-ride bias: ensuring equal access to future commuter rail stations for pedestrians, bicyclists, and bus riders
Yanqiao Wang	UC Berkeley	D-EFFICIENT OR DEFICIENT? 1 2 A Robustness Analysis of SP Experimental Designs in a VOT Estimation Context
Jiao Zhou	Cal Poly Pomona	Assessment of the Performance of Diverging Diamond Interchange

**MAIN LEVEL**

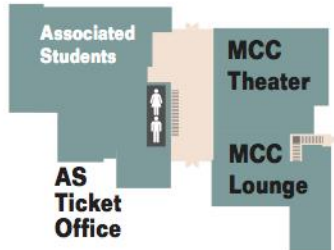

**MEETING ROOMS**

**MAIN LEVEL**  
 SB Mission  
 Flying A Studios

**LOWER LEVEL**  
 SB Harbor  
 Lobero  
 State Street  
 Goleta Valley  
 Chumash

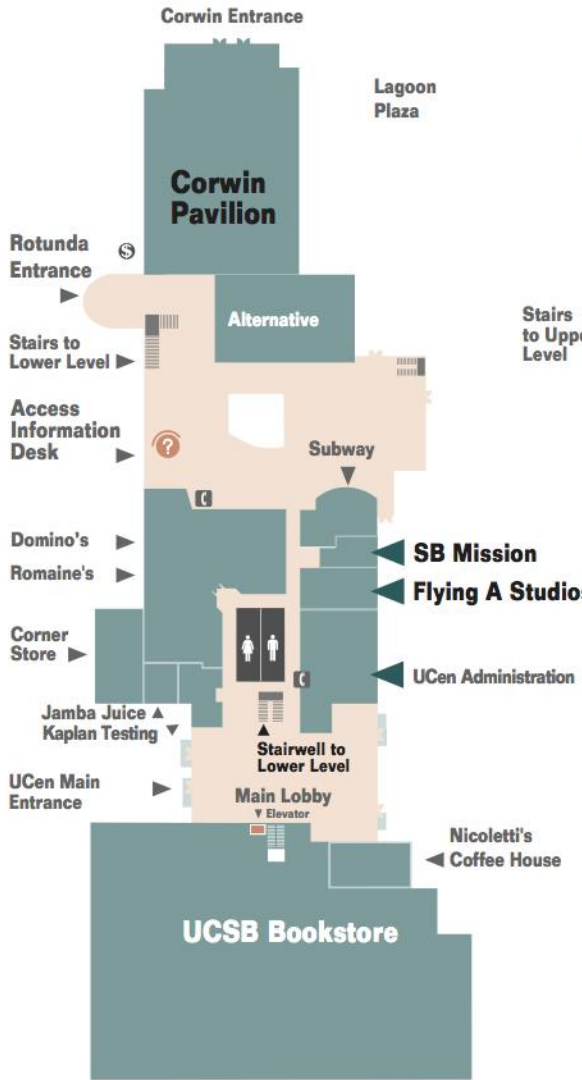

**LOWER LEVEL**



Lagoon Side

SB Harbor  
 Lobero  
 State Street  
 Goleta Valley  
 Chumash

